

POS.NO.	DESCRIPTION	SPARE PART NO.
1 DC*	Dust Controller.....	80 001DC
2	Grid lid (hinge 100 mm).....	80 002
3	Mixer drum, excl. mixer gate.....	80 003
3 R	Rubber strap for grid lid.....	80 003R
4	Frame, complete w/wheels.....	80 004
4 B	Bucket stand.....	80 004B
4 F	Frame, front — u-shape.....	80 004F
4 L	Frame, left side.....	80 004L
4 R	Frame, right side.....	80 004R
4 T	Frame, top/rear.....	80 004T
5	Loading wheel (1 pc.), 80 mm, excl. bolt.....	80 005
5 B	Bolt (1 pc.) for 80 mm loading wheel.....	80 005B
6	Wheel (1 pc.), 300 mm, excl. bolt.....	80 006
6 B	Bolt (1 pc.) for 300 mm wheel.....	80 006B
6 W	Washer (1 pc.) for 300 mm wheel.....	80 006W
7	Mixer gate incl. bolt.....	80 007
8	Switch 9.5 Amp. w/thermal circuit breaker.....	80 008
8 E	Safety switch — by the grid lid.....	80 008E
8 K	Cassette for safety switch, complete.....	80 008K
8 K1	Piece for safety switch, bended metal part.....	80 008K1
8 K2	Piece for safety switch, twisted metal part.....	80 008K2
8 K3	Piece for safety switch, rubber part.....	80 008K3
8 K4	Piece for safety switch, sleigh.....	80 008K4
9	Mixer arm (1 pc.), Side.....	80 009
10	Mixer arm (1 pc.), Side-base.....	80 010
11	Mixer arm (1 pc.), Rake.....	80 011
12	Drive shaft.....	80 012
12 A	Spring pins, complete set of 4 pcs. incl. a jig.....	80 012A
13	Gear motor 1,1 kW, 30 RPM, 240V.....	80 013
13 G	- Gear only.....	80 013G
13 M	- Motor only.....	80 013M
14	Starting capacitor 125 µF.....	80 014_100-125
15	Operating capacitor 25 µF.....	80 015_25
16	Phase capacitor 20 µF.....	80 016_20
17 B	Telescopic leg (1 pc.), rear.....	80 017B
17 L	Telescopic leg (1 pc.), front — left side.....	80 017L
17 R	Telescopic leg (1 pc.), front — right side.....	80 017R
17 SB	Bolt and nut (1 set) for telescopic leg (1 pc.).....	80 017SB
19	Safety grid — by the mixer gate.....	80 019
20 *	Mixer arms w/rubber, 3 pcs., complete set.....	80 020
20 A*	Mixer arms w/rubber, 3 pcs., wo/cross joint.....	80 020A
21 *	Rubber (replacement set, complete).....	80 021
21 A*	Rubber (replacement set, blades only).....	80 021A
21 B*	Rubber (replacement set, for cross joint only).....	80 021B
22	Mixer arms, 4 pcs., complete set.....	80 022
22 A	Mixer arms, 4 pcs., wo/cross joint.....	80 022A
30	Discharge chute (incl. nuts).....	80 030
44	Cross joint for mixer arms, steel.....	80 044
47 *	Cross joint for mixer arms, rubber.....	80 047
48 *	Mixer arm w/rubber, Rake.....	80 048
49 *	Mixer arm w/rubber, Side-base.....	80 049
50 *	Mixer arm w/rubber, Side.....	80 050
51 *	Bracket for mixer blade, rubber, Rake.....	80 051
52 *	Bracket for mixer blade, rubber, Side-base.....	80 052
53 *	Bracket for mixer blade, rubber, Side.....	80 053

SPARE PART LIST - 80L, 240V

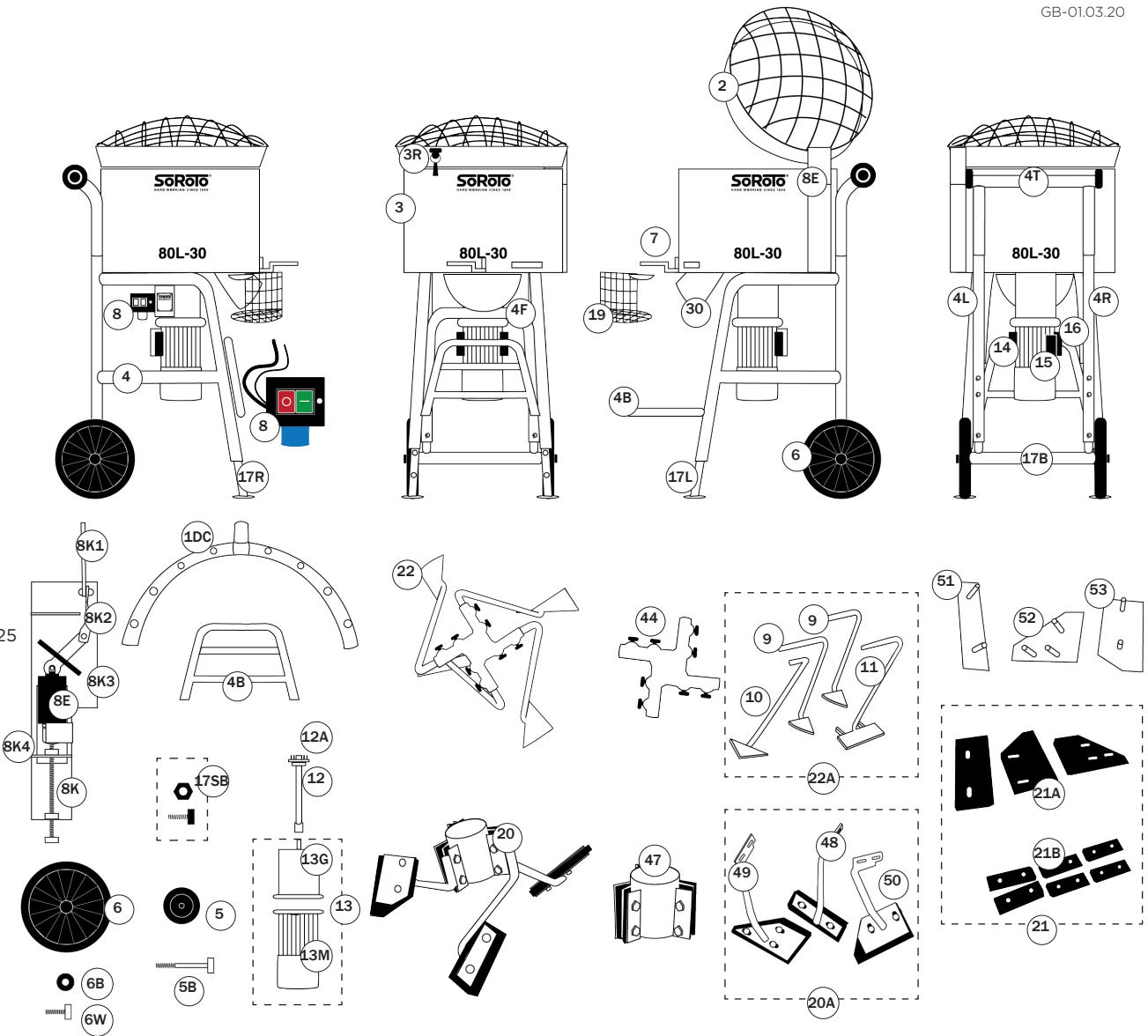

GB-01.03.20



*OPTIONAL EXTRA